

# THUNDER

Products for emergency elevator communications

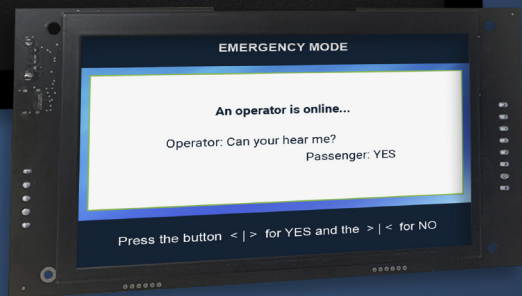

# INSTALLATION OF EMERGENCY KIT

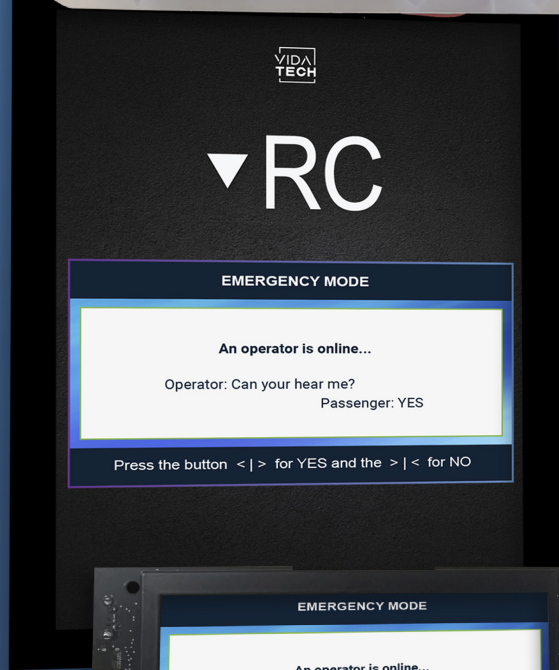
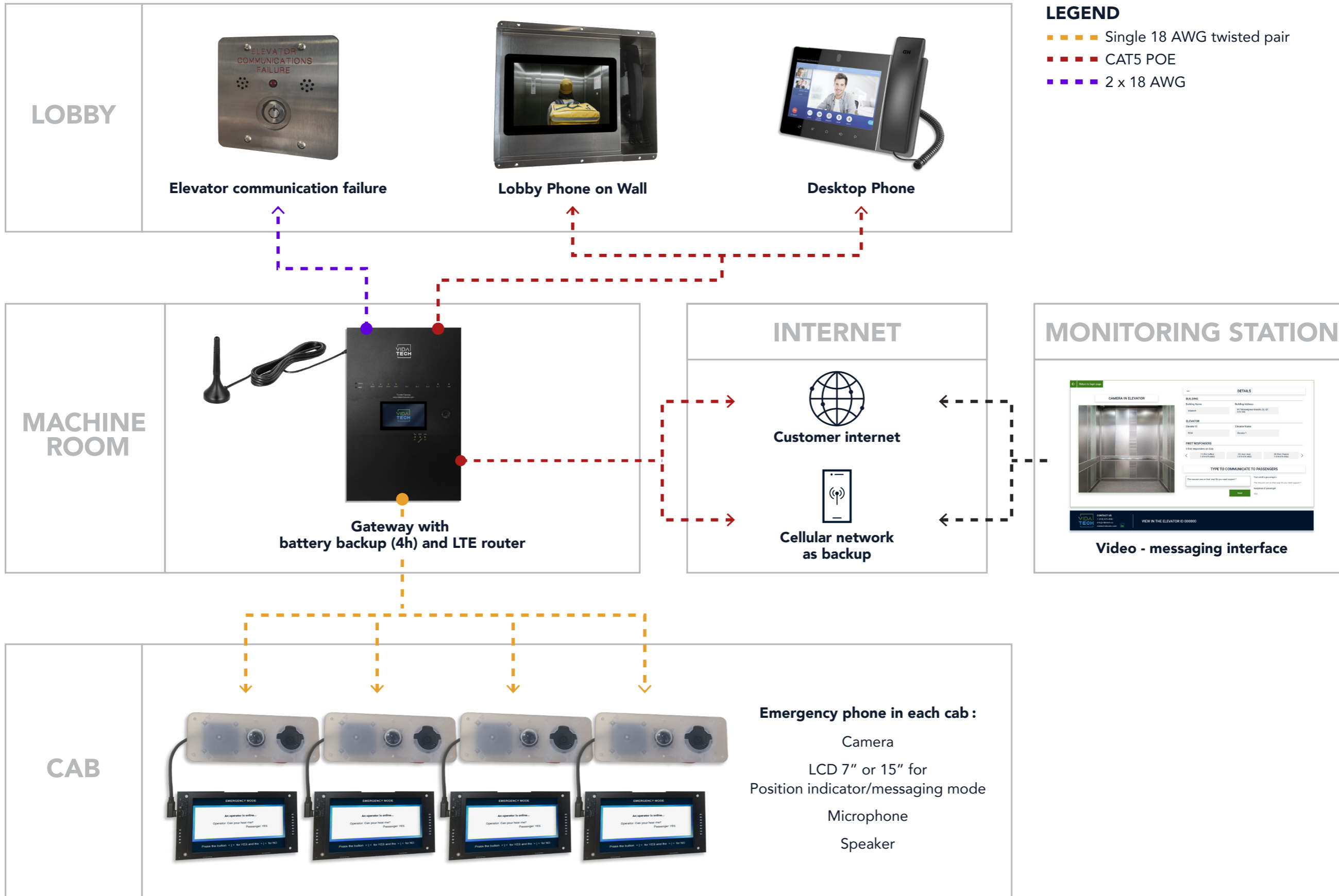

# VIDATECH THUNDER, THE SIMPLEST SOLUTION

## WHY WORK WITH VIDATECH ?

- Fast client support
- Development made internally
- Assemble and tested internally
- VoIP/PBX standard protocol
- Works with standard VoIP applications
- Independent responder platform: No infrastructure required
  - Connect with a link via SMS
  - Connect with a link via email
  - Connect with a 6-digits ID

## ADVANTAGES OF THUNDER :

### SIMPLE DEVICE CABLING

- No external converter or Ethernet switch required
- Twisted pair or CAT5 for every device
- Centralized battery backup

### EASY CONFIGURATION

- Minimum training required
- Dipswitch configurable
- Touchscreen on gateway and Lobby panel for configuration/diagnostics
- No static IP required
- Isolated LAN for emergency communication system
- Web configurable with cloud data provisioning
- Cellular internet as a fallback

### SECURITY

- Isolated Network with a firewall
- Encrypted firmware
- Secured building identification
- Locked gateway

### MONITORING SERVICES : SELECTED FOR NEEDED SERVICES

- VoIP line
- Monitoring station
- Email/SMS alert on system error
- Visual resources web update
- Building/Product configuration
- Cellular fallback



917 Mgr Grandin, Suite 304B  
Quebec City  
Quebec, Canada G1V 3X8  
1 418 476-4802  
info@vidatechelevator.com

# THUNDER TC7082X

Emergency phone in cab



Emergency call 7" display mode

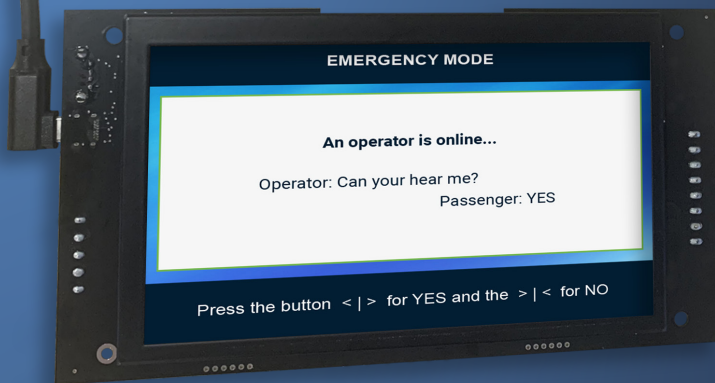

Position indicator 7" display mode



## Features

- ADA, ASME A17.1-2019/CSA B44:19 compliant
  - Full-duplex VoIP
  - 7" color LCD
  - LCD position indicator
  - Voice annunciator
- Self-diagnostic as required per code
- Upgradable remotely or with USB drive
  - Dipswitch configurable

## Camera module

- Code compliant with entire floor view
- Easy installation in COP: One cable for audio, microphone, video
- External PoE port available as an option



917 Mgr Grandin, Suite 304B  
Quebec City  
Quebec, Canada G1V 3X8

1 418 476-4802  
info@vidatechelevator.com

TO ORDER : **TC7082X**

Ethernet switch  
" " : None  
"S" : With switch

# THUNDER TC1582X

Emergency phone in cab



Emergency call 15" display mode

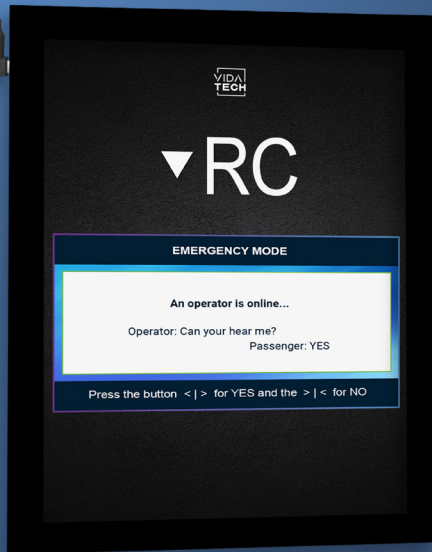

Position indicator 15" display mode



## Features

- ADA, ASME A17.1-2019/CSA B44:19 compliant
  - Full-duplex VoIP
  - 15" color LCD
  - LCD position indicator
- Advertising/Announcement display
  - Voice annunciator
- Self-diagnostic as required per code
- Upgradable remotely or with USB drive
- Customizable graphics via web platform
  - Dipswitch configurable

## Camera module

- Code compliant with entire floor view
- Easy installation in COP: One cable for audio, microphone, video
- External PoE port available as an option



917 Mgr Grandin, Suite 304B  
Quebec City  
Quebec, Canada G1V 3X8

1 418 476-4802  
info@vidatechelevator.com

TO ORDER : **TC1582X**

Ethernet switch  
" ": None  
"S": With switch

# THUNDER TP7012

Desktop phone



## Features and Benefits

- Full-duplex VoIP
- Video communication with cabin
  - Text messaging with cabin
  - Display all cabin cameras
  - 7" touchscreen LCD display
  - Hands-free mode supported
- Powered by PoE or external source
  - No configuration required



917 Mgr Grandin, Suite 304B  
Quebec City  
Quebec, Canada G1V 3X8

1 418 476-4802  
info@vidatechelevator.com

# THUNDER TP1022

Lobby phone



## Features and Benefits

- Full-duplex VoIP
- Video communication with cabin
  - Text messaging with cabin
  - Display all cabin cameras
- 10.1" touchscreen LCD display
- Powered by PoE (4 hours backup)
- Dipswitch and web configurable
- Upgradable remotely or with USB drive
  - Self-diagnostic as required per code
    - Lockable door



917 Mgr Grandin, Suite 304B  
Quebec City  
Quebec, Canada G1V 3X8

1 418 476-4802  
info@vidatechelevator.com

# THUNDER TG10XX

Gateway

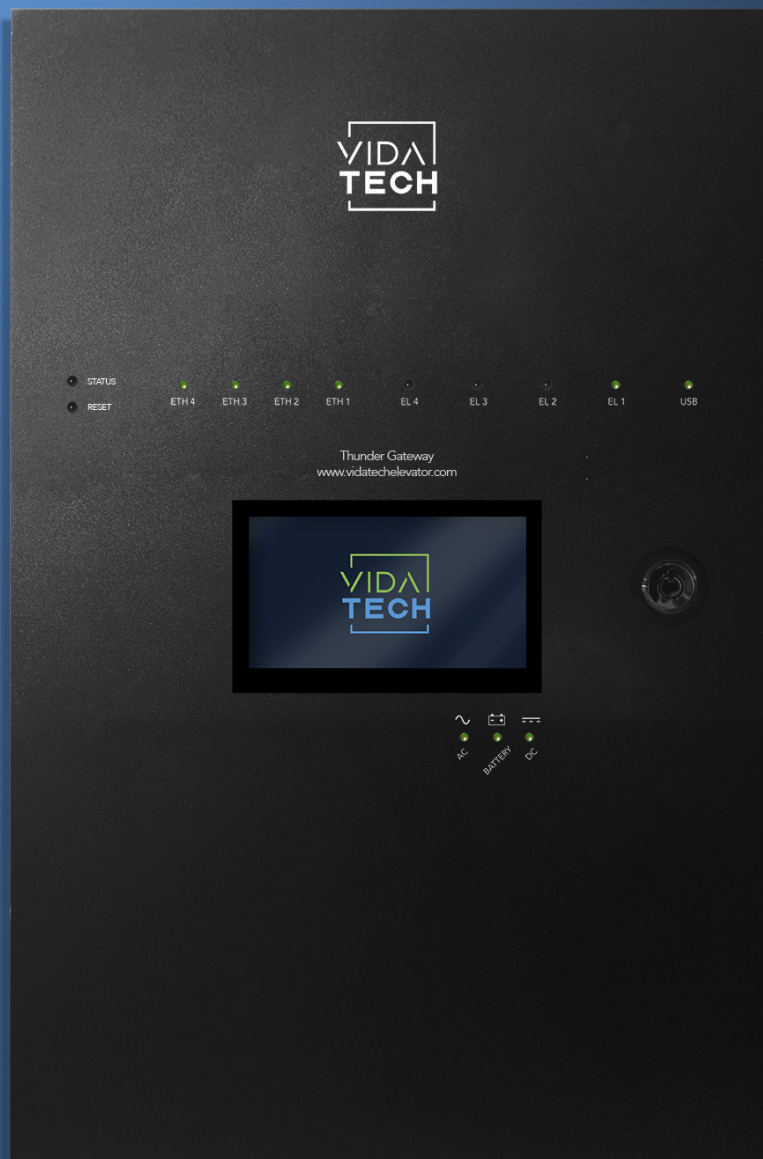

## Features and Benefits

- ASME A17.1-2019/CSA B44:19 compliant
  - Includes 4h+ of battery backup
  - Includes LTE Gateway module
- Available for 2 or 4 cabin configuration
  - Available with 2 or 4 PoE ports
    - 4.3" color LCD
- Constantly diagnoses system state
  - Lockable door
- Multiple Configuration Methods:
  - Through 4.3" touchscreen
  - Through Web platform
  - Through USB drive



917 Mgr Grandin, Suite 304B  
Quebec City  
Quebec, Canada G1V 3X8

1 418 476-4802  
info@vidatechelevator.com

TO ORDER :

TG10XX



Number of elevators  
"2"  
"4"



# THUNDER TA0000

Hall station

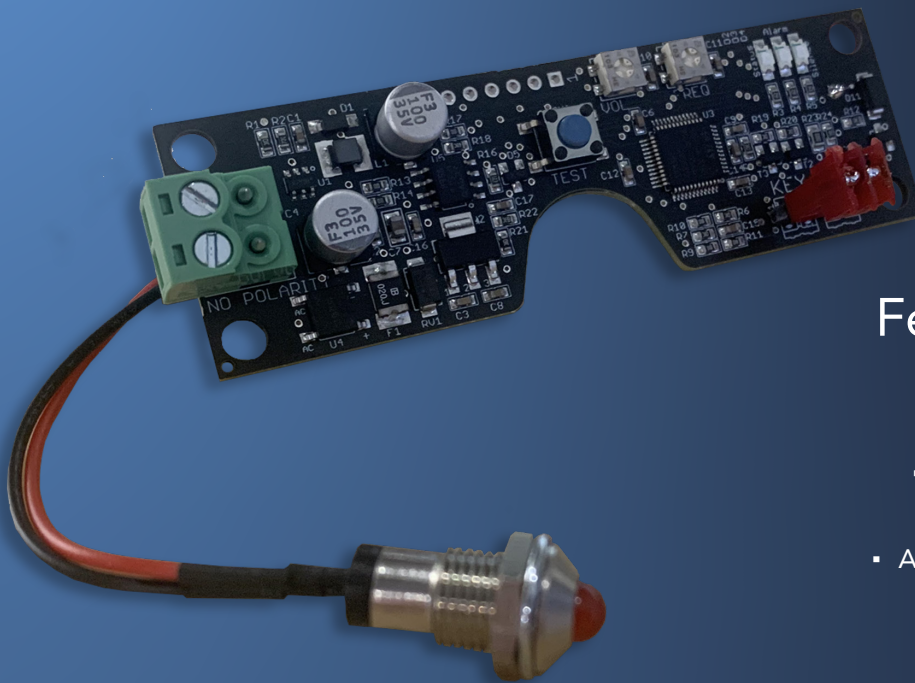

## Features and Benefits

- Audible buzzer for system fault
- Visual indication of system fault
- Key switch to silence audible alarm
  - LED indicator included
- ASME A17.1-2019/CSA B44:19 compliant



917 Mgr Grandin, Suite 304B  
Quebec City  
Quebec, Canada G1V 3X8

1 418 476-4802  
info@vidatechelevator.com